

Master-PVC L-F L

Soft PVC ducting,
reinforced with high
tensile steel wire helix



Material

spiral: encapsulated PVC coated high tensile steel wire

wall: soft PVC

Film thickness between spirals approx. 0.35mm

Applications

- Automotive industry
- Industrial fumes
- General dust under low pressure and vacuum

Properties

- light duty
- very flexible
- lightweight
- small bend radius
- flame retardant

Temperature Range

- 0°C to +70°C
- peaks to +80°C

Master-PVC L-F L

| DN | op. pressure c. bar | vacuum c. mmWC | bend radius c. mm* | outer Ø c. mm | weight c. kg/m | article no. | stock length |
|-----|------------------------|-------------------|-----------------------|------------------|-------------------|---------------|-----------------|
| 25 | 1.5 | 0.18 | 13 | 30 | 0.15 | 662L-025-1000 | 10 |
| 32 | 1.3 | 0.18 | 16 | 37 | 0.15 | 662L-032-1000 | 10 |
| 38 | 1.2 | 0.18 | 20 | 43 | 0.20 | 662L-038-1000 | 10 |
| 45 | 1.1 | 0.14 | 23 | 50 | 0.25 | 662L-045-1000 | 10 |
| 51 | 1.1 | 0.13 | 26 | 56 | 0.30 | 662L-051-1000 | 10 |
| 57 | 1.0 | 0.12 | 28 | 62 | 0.32 | 662L-057-1000 | 10 |
| 63 | 0.8 | 0.12 | 31 | 68 | 0.35 | 662L-063-1000 | 10 |
| 76 | 0.6 | 0.08 | 38 | 81 | 0.60 | 662L-076-1000 | 10 |
| 80 | 0.5 | 0.08 | 38 | 85 | 0.65 | 662L-080-1000 | 10 |
| 89 | 0.5 | 0.07 | 45 | 94 | 0.70 | 662L-089-1000 | 10 |
| 102 | 0.4 | 0.06 | 50 | 107 | 0.75 | 662L-102-1000 | 10 |
| 115 | 0.2 | 0.04 | 58 | 120 | 0.80 | 662L-115-1000 | 10 |
| 127 | 0.2 | 0.03 | 64 | 132 | 0.85 | 662L-127-1000 | 10 |
| 152 | 0.1 | 0.02 | 76 | 158 | 0.90 | 662L-152-1000 | 10 |

All data refers to a media and ambient temperature of +20 °C
 * refers to the inside of the hose
 Available from stock in the above listed lengths and sizes.
 Available on request in other lengths and sizes with print.
 Subject to technical changes and colour deviations.

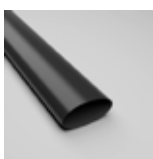

Heat-Shrink Cuff



Master-Grip Hose Clamp,
screwable



Master-Grip Quick-Fix
Clamp

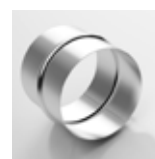

Hose Connector



Hose Reducer,
symmetrical